

Unit Information

50 / 60Hz – 11.25 Amps – Watts 2700
 Toasts 360 Slices per hr.

WARING COMMERCIAL

240 Volt Heavy Duty Toaster
 Switchable bread / bagel controls,
 four 1½" extra-wide slots;

WCT855



CAUTION: DO NOT IMMERSE IN WATER.
ATTENTION: NE PAS IMMERGER DANS L'EAU
WARNING: TO PREVENT ELECTRIC SHOCK, UNPLUG BEFORE CLEANING.
AVERTISSEMENT: AFIN DE RÉDUIRE LE RISQUE D'ÉLECTROCUTION, DÉBRANCHER L'APPAREIL AVANT DE LE NETTOYER.
 APPROVED FOR COMMERCIAL USE/APPROUVÉ POUR USAGE COMMERCIAL
 SERIAL / NO. SÉRIE :

Date Code Location
 YY|MM|DD
 year year | month month | day day

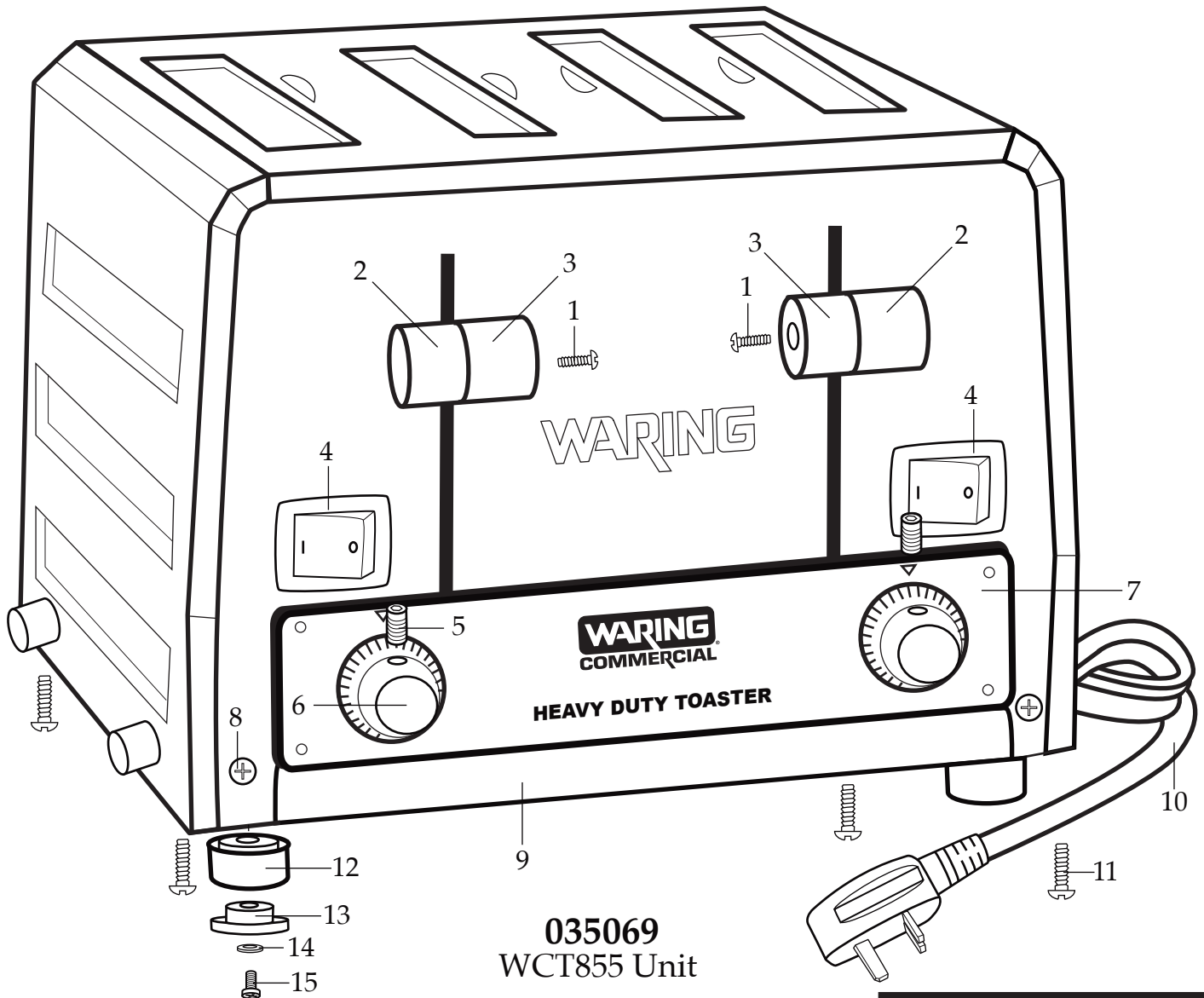

035069
 WCT855 Unit



WARING COMMERCIAL®

Unit Components

WCT855

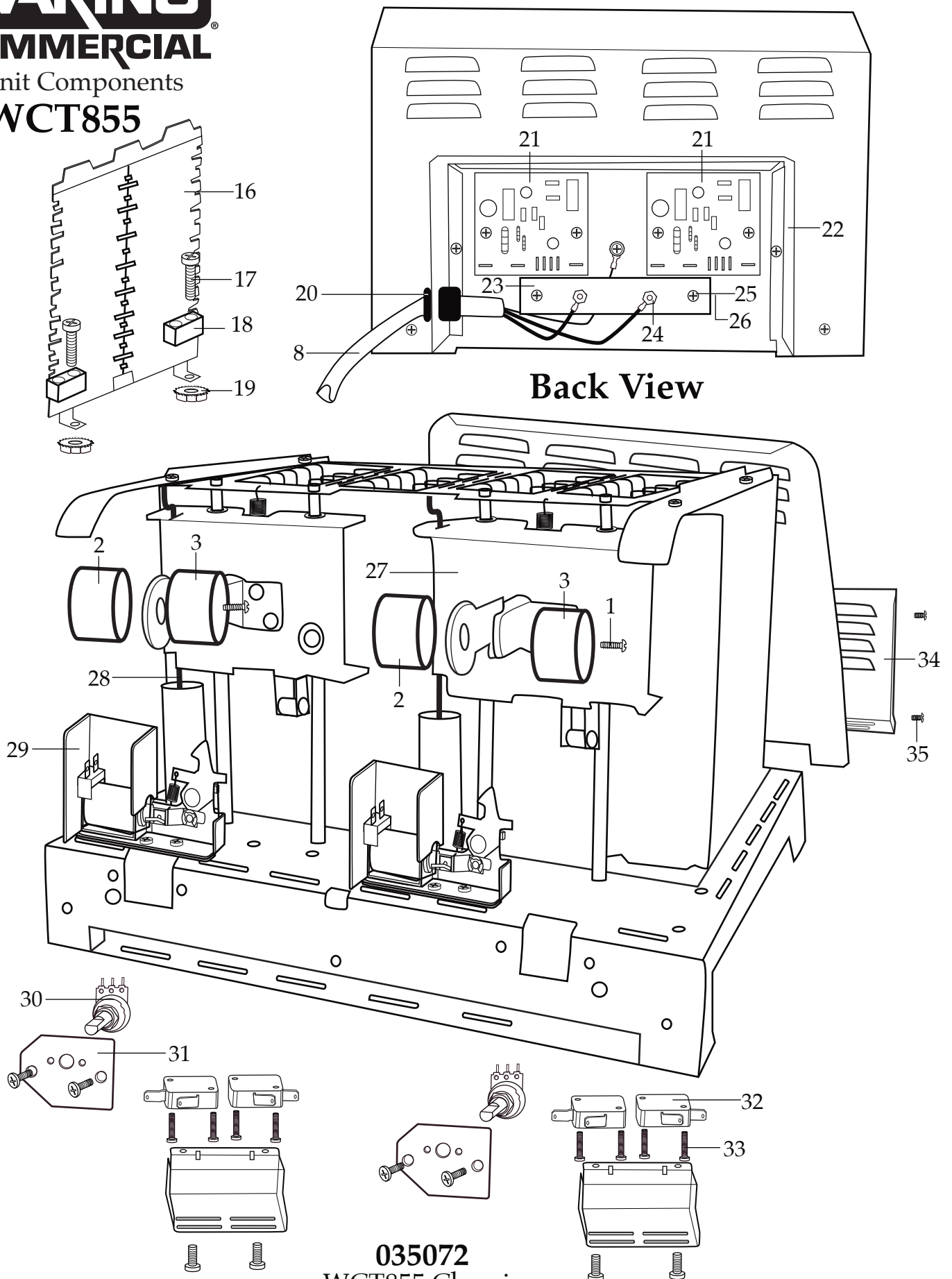

Back View

035072
WCT855 Chassis

| Illustration # | Part # | Description |
|-----------------------|---------------|---|
| 1 | 027172 | Screw (2 required) |
| 2 | 027170 | Push Knob (flat outer center 2 required) |
| 3 | 027171 | Push Knob (screw hole in outer center 2 required) |
| 4 | 033455 | Toggle Switch (2 required) |
| 5 | 027173 | Set Screw (2 required) |
| 6 | 027174 | Browning Control Knob (2 required) |
| 7 | 502939 | Front Panel Assembly |
| 8 | 033460 | Screw (2 required) |
| 9 | 033459 | Crumb Tray |
| 10 | 035073 | Cord Set |
| 11 | 027177 | Screw (4 required) |
| 12 | 027178 | Foot (4 required) |
| 13 | 027179 | Rubber Foot (4 required) |
| 14 | 027180 | Washer (4 required) |
| 15 | 027181 | Screw (4 required) |
| 16 | 035070 | Element 16-6102 (4 required) |
| | 035071 | Element 16-6192 (2 required) |
| 17 | 027202 | Screw (12 required) |
| 18 | 027203 | Ceramic Insulator Bracket (12 required) |
| 19 | 027205 | Hex Nut with Lock Washer (12 required) |
| 20 | 027224 | Strain Relief |
| 21 | 033454 | PC Board (2 required) |
| 22 | 027218 | Power Box Body |
| 23 | 027216 | Power Terminal Board |
| 24 | 027215 | Hex Nut (4 required) |
| 25 | 027213 | Screw (2 required) |

| Illustration # | Part # | Description |
|----------------|--------|--|
| 26 | 027214 | Power PCB Holder (2 required) |
| 27 | 502941 | Moving Bracket Assembly (2 required) |
| 28 | 027191 | Damper Cylinder Rod (2 required) |
| 29 | 027192 | Locking Mechanism (2 required) |
| 30 | 027198 | Rheostat (2 required) |
| 31 | 027199 | Insulated Bracket Plate (2 required) |
| 32 | 033456 | Micro Switch (4 required) |
| 33 | 034769 | Screw (2 required for each micro switch) |
| 34 | 027184 | Power Box Cover |
| 35 | 033460 | Screw (4 required) |

Note When Changing Elements: Bad elements should be removed one at a time so there is no confusion on what element goes where because some elements are not all the same.

