

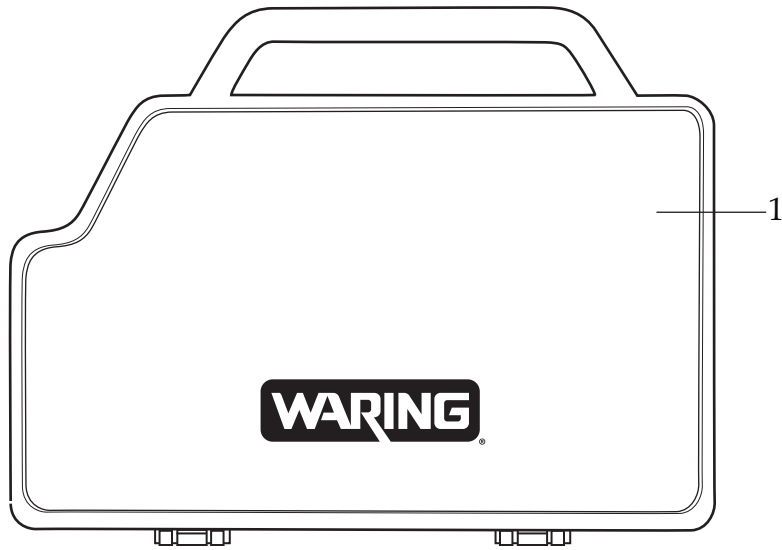

Cordless Lithium Electric Knife

# WEK200



Unit Information	
7.2 VDC – 7.2A Max	
Powered by Heavy-Duty Brush-less DC Motor	
Integrated LED Light for Improved Visibility	
Ergonomic Handle Design Minimizes Fatigue From Extended Use	

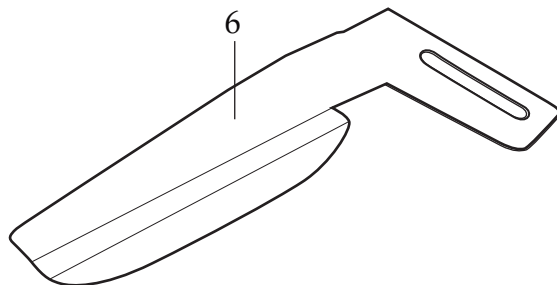
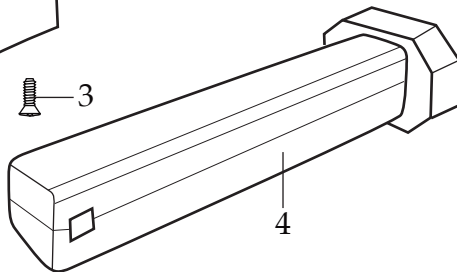
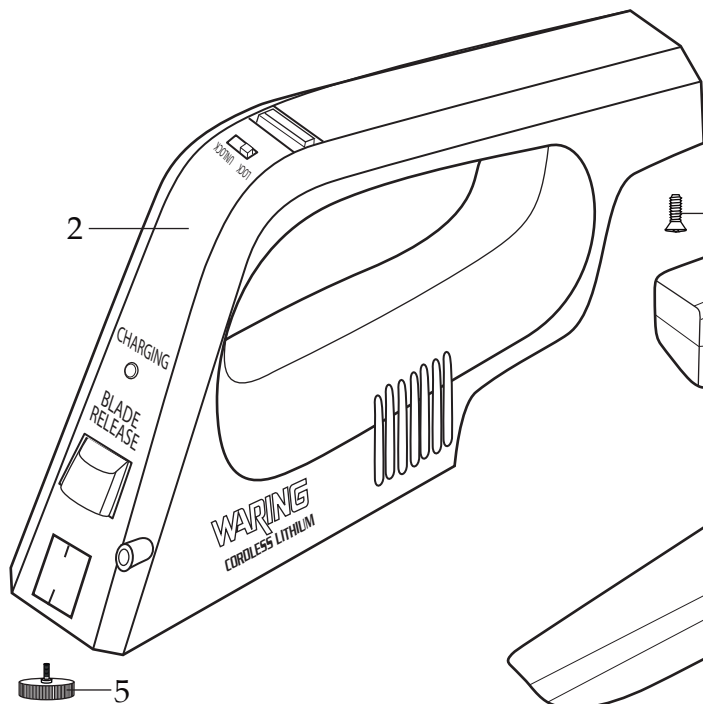

Date Code Location  
YY|MM|DD  
year|year|month|month|day|day

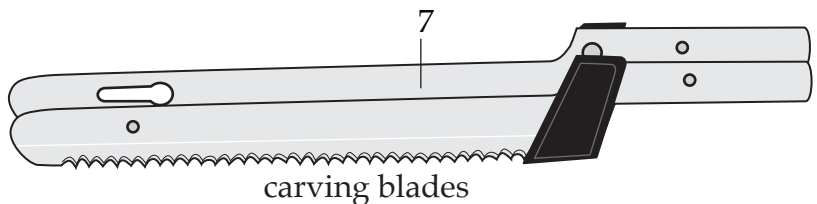
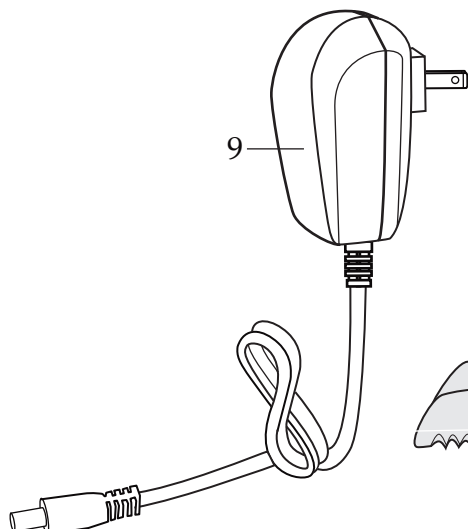
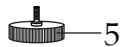

carving blades

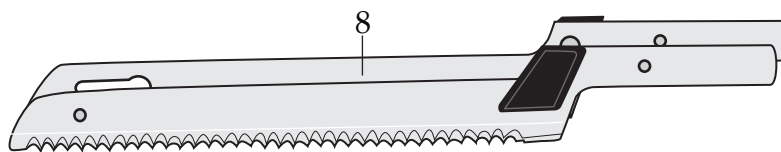

bread blades

<b>Illustration #</b>	<b>Part #</b>	<b>Description</b>
1	035010	Carrying Case
2	035021	WEK200 Unit (with battery pack and thumb screw)
3	035009	Screw (holds battery pack)
4	035003	Lithium Battery Pack
5	035008	Thumb Screw (holds thickness guide)
6	035004	Thickness Guide
7	035006	Set Carving Blades
8	035005	Set Bread Blades
9	035007	Power Adapter